

Property owner's name and address

Water Well Log

Selkirk First Nation  
Pelly Crossing, Y.T.

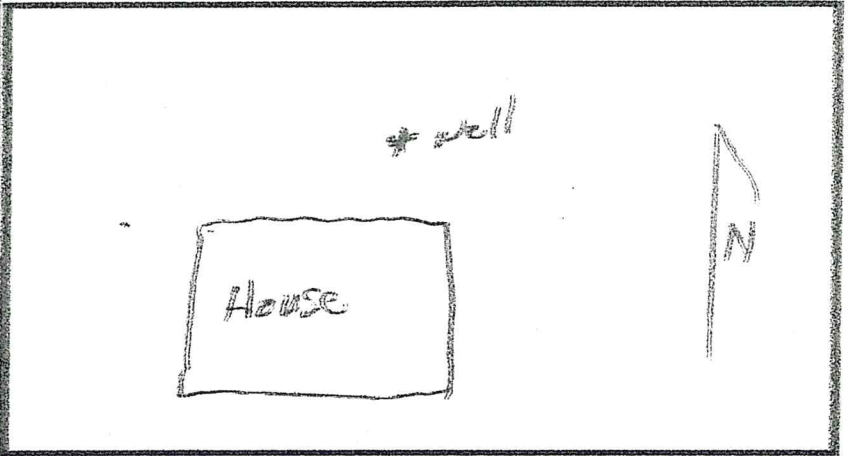

Well site address

Lot 24  
Subd. across River  
Pelly Crossing, Y.T.

Sketch map of well location in the box above

Formation log	colour	hardness	from	to
sandy			0	7
gravel, varying			7	93
occasional boulder				

Well depth 93'  
 Datum point ground  
 Use Domestic  Industrial  
 Municipal Monitoring  
 Other  
 Method of drilling  
 Cable tool Air rotary   
 Other  
 Casing type steel   
 welded  Drill Shoe   
 shoe ID 5 1/2"  
 Hole diameter  
 6" 0-88"  
 4" 88-93  
 Screen stainless .015 slot  
 5' x 5'  
 Development method, duration  
 Air 1 1/2 hr  
 Static water level 75'  
 Specific capacity 7 ± gpm  
 Pump  
 Other information