

# WATER WELL RECORD

Date  YR. MO. DY.

NTS MAP  WELL No.  ELEV  Location Accuracy

U M Z  E  N U M Date 19  Well Type

Owners Name & Address [REDACTED]

Legal Description & Address 10 MILE CREEK TESLIN YUKON

1. TYPE OF WORK
- 1  New Well
  - 2  Reconditioned
  - 3  Deepened
  - 4  Abandoned
2. WORK METHOD
- 1  Cable tool
  - 2  Bored
  - 3  Jetted
  - 4  Rotary a  mud b  air c  reverse
  - Other \_\_\_\_\_
3. WATER WELL USE
- 1  Domestic
  - 2  Municipal
  - 3  Irrigation
  - 4  Comm. & Ind.
  - Other \_\_\_\_\_

4. DRILLING ADDITIVES None

5. MEASUREMENTS from 1  ground level 2  top of casing casing height above ground level \_\_\_\_\_ ft.

FROM ft	TO ft	6. WELL LOG DESCRIPTION	SWL ft
0	5-3"	250 starter pipe DRIVE SHAFT sand & gravel to 10'	
10'	39'	CLAY & small amount of gravel	
	39'	small amount of water in clay & small pieces of gravel	
39'	60-3"	"	
55'			
63-74-11"		Harder CLAY no water	
74-11-79-11"		"	
77'		fine gravel (no water)	
79'		Large Rock no water	
79'		course clean gravel no water	
79'	90'	Hard DRILLING Rock in CLAY & SAND (no water)	
90'		Hit coarse sand with silt and water	
92'		"	

7. CONSULTANT \_\_\_\_\_  
Address \_\_\_\_\_

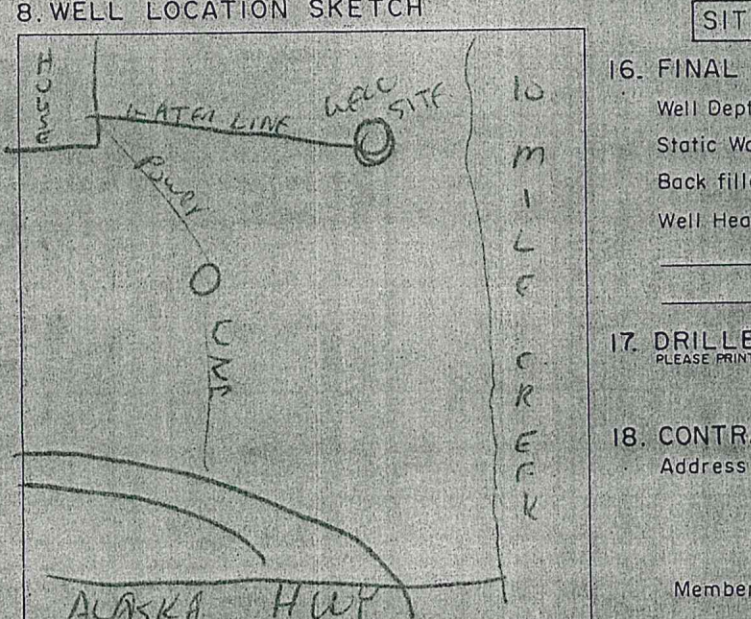

9. CASING: Materials
- 1  Steel
  - 2  Galvanized
  - 3  Wood
  - 4  Plastic
  - 5  Concrete
  - Other \_\_\_\_\_

Hole Diameter	units
Diameter 6"	ins
from _____	ft
to _____	ft
Thickness .188	ins
Weight 12.75	lb/ft

- Pitless unit \_\_\_\_\_ ft 1  above 2  below ground level
- 1  Welded 2  Cemented 3  Threaded 1  New 2  Used

Shoe(s) \_\_\_\_\_

Open hole, from \_\_\_\_\_ to \_\_\_\_\_ ft Diameter \_\_\_\_\_ ins

Grout: None

10. SCREEN: 1  Nominal (Telescope) 2  Pipe Size
- Type 1  Continuous Slot 2  Perforated 3  Louvre
- Other \_\_\_\_\_
- Material 1  Stainless Steel 2  Plastic  Other \_\_\_\_\_
- Set from \_\_\_\_\_ to \_\_\_\_\_ ft below ground level

RISER, SCREEN & BLANKS					units
Length	5 ft	4			ft
Diam. I.D	5"				ins
Slot Size	#10				ins
from _____					ft
to _____					ft

Fittings, top \_\_\_\_\_ bottom \_\_\_\_\_

Gravel Pack None

11. DEVELOPED BY: 1  Surging 2  Jetting 3  Air
- 4  Bailing 5  Pumping  Other \_\_\_\_\_

12. TEST 1  Pump 2  Bail 3  Air Date  YR. MO. DY.

Rate \_\_\_\_\_ USgpm Temp \_\_\_\_\_ °C SWL before test \_\_\_\_\_ ft

Water Level \_\_\_\_\_ ft after test of \_\_\_\_\_ hrs

DRAWDOWN in ft				RECOVERY in ft			
mins	WL	mins	WL	mins	WL	mins	WL
				3:15	53	3:29	40
				3:22	51	3:35	36
				3:27	42-6	3:39	35

13. RECOMMENDED PUMP TYPE \_\_\_\_\_ RECOMMENDED PUMP SETTING \_\_\_\_\_ ft RECOMMENDED PUMPING RATE \_\_\_\_\_ USgpm

14. WATER TYPE: 1  fresh 2  salty 3  clear 4  cloudy

colour \_\_\_\_\_ smell \_\_\_\_\_ ; gas 1  yes 2  no

15. WATER ANALYSIS:

- 1 Hardness \_\_\_\_\_ mg/L
- 2 Iron \_\_\_\_\_ mg/L
- 3 Chloride \_\_\_\_\_ mg/L
- 4 pH \_\_\_\_\_

Field Date \_\_\_\_\_

SITE I D No  Lab Date  YR. MO. DY.

16. FINAL WELL COMPLETION DATA

Well Depth 89-1' ft Well Yield  USgpm

Static Water Level 23 ft Artesian Flow  US gpm Pressure Head  ft

Back filled \_\_\_\_\_

Well Head Completion \_\_\_\_\_

17. DRILLER

PLEASE PRINT

Signature

18. CONTRACTOR

Address

Member, BCWWD A  yes  no ; \_\_\_\_\_

The Province of British Columbia accepts no responsibility for the contents or accuracy of this record.

203020019