

Property owner's name and address

[Redacted]  
 Testin, V.T.

# Water Well Log

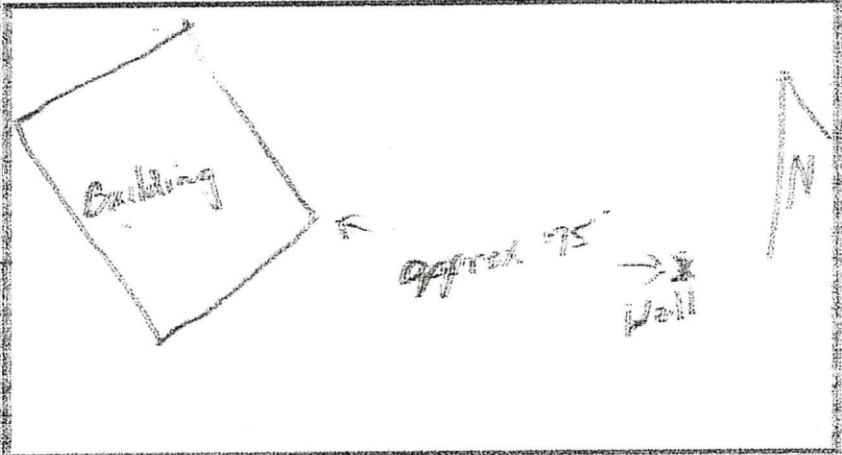

Well site address

Traber Point Testin Lake

Sketch map of well location in the box above

Formation log

color hardness thickness ft

Formation log	color	hardness	thickness	ft
Rocky			0	6
sandy gravel			6	34
varying silt to clay			34	220
clay, some rock			220	245
gravel, some silt			245	250

Well depth 250

Bottom point ground

Use Domestic  Industrial

Municipal  Monitoring

Other

Method of drilling

Cable tool  Air rotary

Other

Casing type steel

welded  Drill shoe

shoe ID 4 1/2"

Hole diameter

5" to 250'

Screen None

Developmental method, duration

Static water level 55'

Specific capacity 20 gpm

Pump

Other information

Whitewater Resources

Driller [Redacted]

Box 33012

Whitehorse, YT. Y1A 5Y5

1-(867) 667-6195

Date completed

Sept. 17/99