

Well ID: 204070016

To be assigned by Dept. Of Environment

**INSTRUCTIONS FOR COMPLETING THE FORM**

1. Additional information is provided at the bottom of this form on page 2.
2. Question can be directed to Water Resources at 867 667-3171.
3. All well construction measurements shall be reported to 0.1 m or 0.3 ft.
4. Please print clearly in blue or black ink.
5. Completion and submission of this form is the responsibility of the drilling contractor. **Property Assessment & Taxation**
6. Please specify metric or imperial units for all measurements.

**WELL LOCATION AND OWNER'S INFORMATION**

A1 Well Name:  Optional (i.e. City Well No.)

A2 Drilled For:

A3 Street Address of Well Location: Bear Creek South Klondike

A4 Town / Village / Area / Lot #: 634 plan 46509 whse

A5 UTM Coordinates (using handheld GPS): NAD 8 3 Zone 08

\* 508669 \* 6700285  
 Easting Northing 30-100m

A6 Elevation of Top of Casing:  m / ft ASL

A7 Accuracy of GPS:  +/- m / ft

**A8 Purpose of Wells**

- |  |                                       |  |   |
|--|---------------------------------------|--|---|
| <input checked="" type="checkbox"/> Domestic | <input type="checkbox"/> Test Well    | <input type="checkbox"/> Irrigation                | <input type="checkbox"/> Environmental (Quality)  |
| <input type="checkbox"/> Commercial          | <input type="checkbox"/> Municipal    | <input type="checkbox"/> Observation - Water Level | <input type="checkbox"/> Other (please identify use)  |
| <input type="checkbox"/> Industrial          | <input type="checkbox"/> Agricultural | <input type="checkbox"/> Public/Recreational       | <span style="border: 1px solid black; display: inline-block; width: 100px; height: 15px;"></span> |

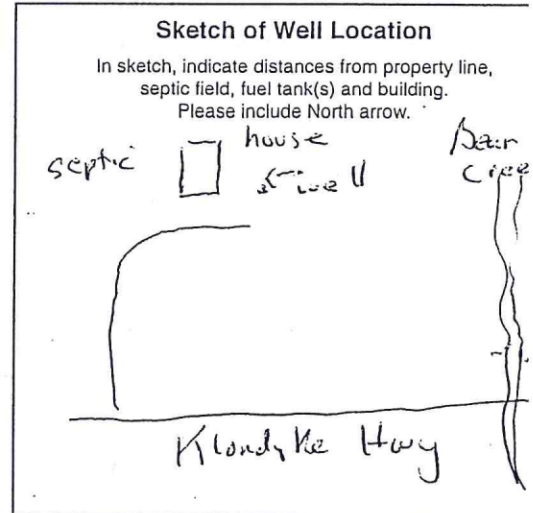

**LOG OF OVERBURDEN AND BEDROCK MATERIALS** (All depths are below ground surface, circle appropriate units, use descriptors provided)

EXAMPLE ONLY →

(brown, grey, green, black, redish, beige, olive, yellowish)

CLAY, SILT, SAND, GRAVEL, COBBLES, BOULDERS, BEDROCK

"trace" <10% (i.e. SILT trace gravel)  
 "some" 10-20% (i.e. SAND some gravel)  
 "silty / sandy / gravelly" 20-30% (i.e. silty SAND)  
 "and sand" or "and gravel" 35-50%

MOISTURE: dry / moist / saturated (wet)  
 HARDNESS: soft / hard / very hard

Depth (m / ft)		B4 General Colour	B5 Most Common Material	B6 Secondary Materials	B7 General Description
B2 From	B3 To				
0	40	Brown	Sand		Dry
<10	80		Sand	gravel	wet
80	98	Brown	Sand		COARSE wet

B8 Permafrost Encountered:  NO  YES If yes, indicated depth (m / ft): from:  to:

**WELL CONSTRUCTION** (Continues on Page 2)

Date Well Completed 201105  
 Y Y Y Y M M D D

Example: 2005 01 31

C1 Drilling Method  Air Rotary (Conventional)  Dug  Other (please specify)  
 Reverse Air Rotary  Cable Tool Dual Rotary  
 Mud Rotary  Auger (Hollow / Solid Stem)

C2 Well Type: In what geological material is water producing zone located  
 OVERBURDEN  BEDROCK

**Casing** (depth below ground surface, please circle appropriate units).

C3 Outside Diameter 6 3/4 (cm / in)  
 C4 Casing Material  Steel  Plastic  Other   
 C5 Casing Wall Thickness 1.219 (cm / in)  
 C6 Casing Depth to: 46 (m / ft)

C7 Other Comments Regarding Casing  
D.R. shoe

## WATER WELL DRILLERS FORM

105D07

Well ID:

To be assigned by Dept. Of Environment

### INSTRUCTIONS FOR COMPLETING THE FORM

- Additional information is provided at the bottom of this form on page 2.
- Question can be directed to Water Resources at 867 667-3171.
- All well construction measurements shall be reported to 0.1 m or 0.3 ft.
- Please print clearly in blue or black ink.
- Completion and submission of this form is the responsibility of the drilling contractor.
- Please specify metric or imperial units for all measurements.

### WELL LOCATION AND OWNER'S INFORMATION

A1 Well Name:  Optional (i.e. City Well No. 2)

A2 Drilled For:

A3 Street Address of Well Location: Bear Creek South Klondike

A4 Town / Village / Area / Lot #: 634 plan 46509 whse

A5 UTM Coordinates (using handheld GPS): NAD 8 3 Zone    

Easting:  Northing:

A6 Elevation of Top of Casing:  m / ft ASL

A7 Accuracy of GPS:  +/- m / ft

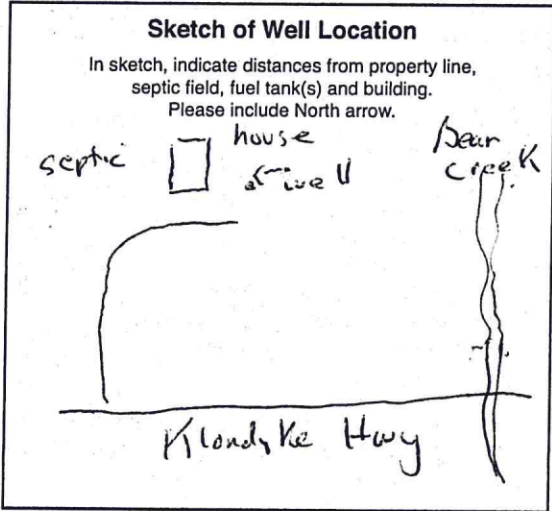

### A8 Purpose of Wells

- |  |                                       |  |  |
|--|---------------------------------------|--|--|
| <input checked="" type="checkbox"/> Domestic | <input type="checkbox"/> Test Well    | <input type="checkbox"/> Irrigation                | <input type="checkbox"/> Environmental (Quality)   |
| <input type="checkbox"/> Commercial          | <input type="checkbox"/> Municipal    | <input type="checkbox"/> Observation - Water Level | <input type="checkbox"/> Other (please identify use)   |
| <input type="checkbox"/> Industrial          | <input type="checkbox"/> Agricultural | <input type="checkbox"/> Public/Recreational       | <span style="border: 1px solid black; display: inline-block; width: 80px; height: 20px;"></span> |

### LOG OF OVERBURDEN AND BEDROCK MATERIALS (All depths are below ground surface, circle appropriate units, use descriptors provided)

#### EXAMPLE ONLY

(brown, grey, green, black, redish, beige, olive, yellowish)

CLAY, SILT, SAND, GRAVEL, COBBLES, BOULDERS, BEDROCK

'trace' <10% (i.e. SILT trace gravel)  
"some" 10-20% (i.e. SAND some gravel)  
"silty / sandy / gravelly" 20-30% (i.e. silty SAND)  
"and sand" or "and gravel" 35-50%

MOISTURE: dry / moist / saturated (wet)  
HARDNESS: soft / hard / very hard

Depth (m / ft)		B4 General Colour	B5 Most Common Material	B6 Secondary Materials	B7 General Description
B2 From	B3 To				
0	40	brown	Sand	trace gravel some silt	Dry
40	86		Sand	gravel	wet
80	98	Brown	Sand		COARSE wet

B8 Permafrost Encountered:  NO  YES If yes, indicated depth (m / ft): from:  to:

WELL CONSTRUCTION (Continues on Page 2) Date Well Completed 201105    
Y Y Y Y M M D D

Example: 2005 01 31

C1 Drilling Method  Air Rotary (Conventional)  Dug  Other (please specify)  
 Reverse Air Rotary  Cable Tool  Dual Rotary  
 Mud Rotary  Auger (Hollow / Solid Stem)

C2 Well Type: In what geological material is the water producing zone located?  
 OVERBURDEN  BEDROCK

Casing (depth below ground surface, please circle appropriate units)  
C3 Outside Diameter 65 (cm / in)  
C4 Casing Material  Steel  Plastic  Other   
C5 Casing Wall Thickness 21 (cm / in)  
C6 Casing Depth to: 96 (m / ft)

C7 Other Comments Regarding Casing:  
D.R. shoe