

WATER WELL DRILLERS FORM

Well ID: 204100513

To be assigned by Dept. Of Environment

105D10

105D10

INSTRUCTIONS FOR COMPLETING THE FORM

1. Additional information is provided at the bottom of this form on page 2.
2. Question can be directed to Water Resources at 867 667-3171.
3. All well construction measurements shall be reported to 0.1 m or 0.3 ft.
4. Please print clearly in blue or black ink.
5. Completion and submission of this form is the responsibility of the drilling contractor.
6. Please specify metric or imperial units for all measurements.

WELL LOCATION AND OWNER'S INFORMATION

A1 Well Name: Optional (i.e. City Well No. 2)

A2 Drilled For: First Name: Last Name: Company / Department / Organization:

A3 Street Address of Well Location: Lot 152 Venus Place

A4 Town / Village / Area / Lot #: Plan 68723 Quad 105D/10
Golden Horn Sub

A5 UTM Coordinates (using handheld GPS): NAD 8 | 3 Zone 0 | P

5 | 0 | 8 | 2 | 3 | 2 Easting 6 | 7 | 1 | 9 | 4 | 2 | 5 Northing

A6 Elevation of Top of Casing: 728 (m) ft ASL

A7 Accuracy of GPS: +/- 10 m +/- m / ft

A8 Purpose of Wells

- Domestic Test Well Irrigation Environmental (Quality)
 Commercial Municipal Observation - Water Level Other (please identify use)
 Industrial Agricultural Public/Recreational

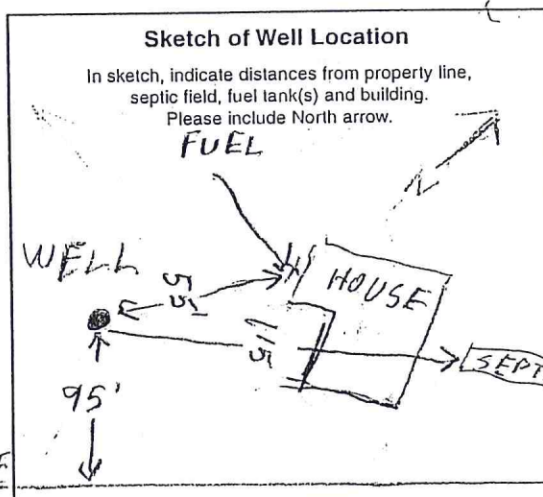

LOG OF OVERBURDEN AND BEDROCK MATERIALS (All depths are below ground surface, circle appropriate units, use descriptors provided)

EXAMPLE ONLY →

(brown, grey, green, black, redish, beige, olive, yellowish)

CLAY, SILT, SAND, GRAVEL, COBBLES, BOULDERS, BEDROCK

"trace" <10% (i.e. SILT trace gravel)
"some" 10-20% (i.e. SAND some gravel)
"silty / sandy / gravelly" 20-30% (i.e. silty SAND)
"and sand" or "and gravel" 35-50%

MOISTURE: dry / moist / saturated (wet)
HARDNESS: soft / hard / very hard

Depth (m (ft))		B4 General Colour	B5 Most Common Material	B6 Secondary Materials	B7 General Description
B2 From	B3 To				
0	114	Grey	Clay	Silt	Hard
114	118	Grey	Gravel		Very little Water
118	160		Gravel	Silt / Clay	
160	170	Brown	Sand	Gravel Layer	Pressurized

B8 Permafrost Encountered: NO YES If yes, indicated depth (m / ft): from: to:

WELL CONSTRUCTION (Continues on Page 2) Date Well Completed 20090609
Y Y Y Y M M D D

Example: 2005 01 31

C1 Drilling Method Air Rotary (Conventional) Dug Other (please specify) Dual Rotary
 Reverse Air Rotary Cable Tool
 Mud Rotary Auger (Hollow / Solid Stem)

C2 Well Type: In what geological material is the water producing zone located?
 OVERBURDEN BEDROCK

Casing (depth below ground surface, please circle appropriate units)
 C3 Outside Diameter 6 5/8 (cm (in))
 C4 Casing Material Steel Plastic Other
 C5 Casing Wall Thickness .250 (mm (in))
 C6 Casing Depth to: 162 (m (ft))

C7 Other Comments Regarding Casing:

Surface / Environmental Seal (depth below ground surface, please circle appropriate units)

C8 Seal Material Type: Bentonite (i.e. Bentonite)
C9 Diameter of Seal: 10 (cm/in)
C10 Seal Depth from: 0 (m/ft)
C11 Seal Depth to: 15 (m/ft)
C12 Volume Placed: (m³/ft³)

Gravel Pack (depth below ground surface, please circle appropriate units)

C13 Gravel Pack: [X] NO If yes, indicated depth (m/ft): from: to: Indicate diameter of material: (mm/inches) Material type: (i.e. silica)

Well Screen Information (depth below ground surface, please circle appropriate units)

C14 Outside Diameter: 6 (cm/in)
C15 Screen Material: [X] Stainless Steel
C16 Screen Type: [X] Continuous Wire Wrap
C17 Depth from: 16.9 (m/ft)
C18 Depth to: 16.5 (m/ft)
Slot Size / Perforation: 12 Thou./mm/in

WELL DEVELOPMENT AND STATUS

D1 Well Developed by: [X] Air Jetting / Air Lifting
D2 Well Head Completion: [X] Pitless Adaptor
D3 Well Head Stick-up: 1.5 (m/ft)
D4 Static Water Level: 37 (m/ft)
D5 Well Yield Estimate: 15+ (Lps/gpm)
D6 Final Well Status: [X] Water Supply (in use)
D7 Well Abandonment Status: Was the well properly decommissioned with bentonite grout? [] YES [] NO
D8 Method Used to Estimate Well Yield: [X] Air Lifting

PUMPING TEST RECORD AND GROUNDWATER QUALITY

(All depths below ground, circle appropriate units)

E1 Pumping Test Information

Pumping Test Start Date: Y Y Y Y M M D D

Static Water Level (SWL): (m/ft)

Pump Intake Set at: (m/ft)

Duration of pumping: hrs min

Final Water Level (FWL) at end of Pumping Test: (m/ft)

RECOMMENDATIONS

Recomm. Pump Depth: (m/ft)
Recomm. Pumping Rate: (Lps/gpm)
If flowing, provide rate: (Lps/gpm)

F1 Well Water Level Drawdown/Recovery DATA

Table with columns for Time (min), Water Level (m/ft) for Drawdown and Recovery. Rows include 0 (SWL), 1, 2, 3, 4, 5, 10, 15, 20, 25, 30, 40, 50, 60.

G1 GROUNDWATER QUALITY

Field Data

Date Measurements Taken: Y Y Y Y M M D D

Electrical Conductivity: uS
pH:
Temperature: °C

Turbidity/Sand Content

[] Clear
[] Slightly turbid/cloudy
[] Moderately turbid/cloudy
[] Turbid/cloudy
[] Trace sand present
[] No sand present

Groundwater Type

[] Salty
[] Sulphur / Egg Odour
[] Organic Taste / Odour
[] Metallic Taste
[] Other:

Well Disinfection

Was the well disinfected upon completion of the pump installation? [] YES [] NO

Briefly describe method of well disinfection.

Javex

Bacteria Testing

Was a sample taken? [] YES [] NO If yes, indicate the name of the laboratory.

Date Sample Taken: Y Y Y Y M M D D

Chemical Analysis of Water

Was a sample taken? [] YES [] NO If yes, indicate the name of the laboratory.

Date Sample Taken: Y Y Y Y M M D D

WELL CONTRACTOR

H1 Name of Contractor / Drilling Company: Impact Well Drilling

H2 Name of Driller(s):

H3 Address of Driller:

Signature of Primary Driller: [Signature]
Date Submitted to Dept. Of Environment: 2011001217

CONSULTANT (If applicable)

I 1 Company Name:

I 2 Company Address:

I 3 Report Reference:

I 4 Report Date: Y Y Y Y M M D D

ADDITIONAL INSTRUCTIONS

Upon completing this form, please mail or fax it to: Water Resources Section (V-310), Department of Environment, Government of Yukon Box 2703, Whitehorse, Yukon, Canada Y1A 2C6

Please feel free to contact us at: Phone: (867) 667-3171, Toll free (in Yukon): (1-800) 661-0408, local 3171 Fax: (867) 667-3195 E-mail: Water.Resources@gov.yk.ca

Personal information contained on this form is collected under the authority of the Access to Information and Protection of Privacy (ATIP) Act, Section 29 (c) and will be used to compile a public database of well and ground water information. For further information contact the Manager of Hydrology, Water Resources at (867) 667-3223, toll free within Yukon 1-800-661-0408 Ext 3223.

I have read the above clause and understand the purpose for collection of personal information. Signature of Well Owner