

Well ID: 204100515
To be assigned by Dept. Of Environment

105010

152

105010

INSTRUCTIONS FOR COMPLETING THE FORM

- Additional information is provided at the bottom of this form on page 2.
- Question can be directed to Water Resources at 867 667-3171.
- All well construction measurements shall be reported to 0.1 m or 0.3 ft.
- Please print clearly in blue or black ink.
- Completion and submission of this form is the responsibility of the drilling contractor.
- Please specify metric or imperial units for all measurements.

WELL LOCATION AND OWNER'S INFORMATION

A1 Well Name: Optional (i.e. City Well No. 2)

A2 Drilled For: [Redacted] Company / Department / Organization

A3 Street Address of Well Location: Lot 184 Plan 73159

A4 Town / Village / Area / Lot #: Golde horn Ahse Y.T

A5 UTM Coordinates (using handheld GPS): NAD 8 3 Zone 1 1

5 10 0 6 7 7 9 6 7 1 7 4 6 2
Easting Northing

A6 Elevation of Top of Casing: 752 m / ft ASL

A7 Accuracy of GPS: 6 m +/- m / ft

A8 Purpose of Wells

- | | | | |
|-------------------------------------|---------------------------------------|--|---|
| <input type="checkbox"/> Domestic | <input type="checkbox"/> Test Well | <input type="checkbox"/> Irrigation | <input type="checkbox"/> Environmental (Quality) |
| <input type="checkbox"/> Commercial | <input type="checkbox"/> Municipal | <input type="checkbox"/> Observation - Water Level | <input type="checkbox"/> Other (please identify use) |
| <input type="checkbox"/> Industrial | <input type="checkbox"/> Agricultural | <input type="checkbox"/> Public/Recreational | |

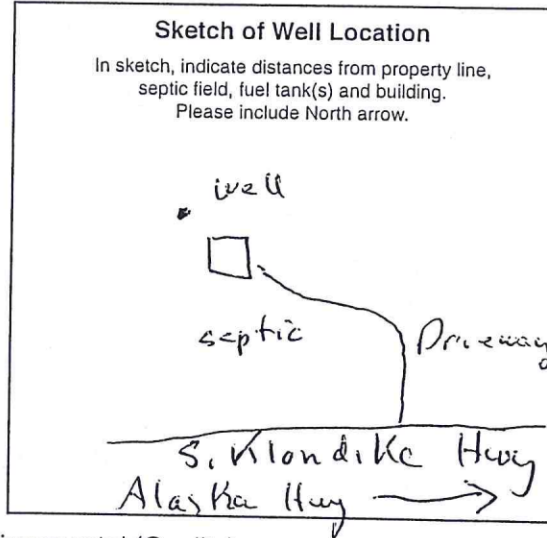

LOG OF OVERBURDEN AND BEDROCK MATERIALS (All depths are below ground surface, circle appropriate units, use descriptors provided)

EXAMPLE ONLY		(brown, grey, green, black, reddish, beige, olive, yellowish)	CLAY, SILT, SAND, GRAVEL, COBBLES, BOULDERS, BEDROCK	"trace" <10% (i.e. SILT trace gravel) "some" 10-20% (i.e. SAND some gravel) "silty / sandy / gravelly" 20-30% (i.e. silty SAND) "and sand" or "and gravel" 35-50%	MOISTURE: dry / moist / saturated (wet) HARDNESS: soft / hard / very hard
		brown	SAND	trace gravel some silt	soft and saturated
Depth (m / ft)		B4 General Colour	B5 Most Common Material	B6 Secondary Materials	B7 General Description
B2 From	B3 To				
0	7	brown	clay	gravel	brown
7	480	green black	bedrock		granite hard

B8 Permafrost Encountered: NO YES If yes, indicated depth (m / ft): from: to:

WELL CONSTRUCTION (Continues on Page 2)

Date Well Completed 20 10 09 1 1
Y Y Y Y M M D D

Example: 2005 01 31

C1 Drilling Method Air Rotary (Conventional) Dug Other (please specify)
 Reverse Air Rotary Cable Tool Dual Rotary
 Mud Rotary Auger (Hollow / Solid Stem)

C2 Well Type: In what geological material is the water producing zone located?
 OVERBURDEN BEDROCK

Casing (depth below ground surface, please circle appropriate units)

C3 Outside Diameter 67.8 (cm / in)
C4 Casing Material Steel Plastic Other
C5 Casing Wall Thickness 2.19 (cm / in)
C6 Casing Depth to: 17 (m / ft)

C7 Other Comments Regarding Casing:

Surface / Environmental Seal (depth below ground surface, please circle appropriate units)

C8 Seal Material Type: Bentonite (i.e. Bentonite)
C9 Diameter of Seal: 10" (cm/in)
C10 Seal Depth from: 6 (m/ft)
C11 Seal Depth to: 15 (m/ft)
C12 Volume Placed: (m³/ft³)

Gravel Pack (depth below ground surface, please circle appropriate units)

C13 Gravel Pack: [X] NO If yes, indicated depth (m/ft): from: to: Indicate diameter of material: (mm/inches) Material type:

Well Screen Information (depth below ground surface, please circle appropriate units)

C14 Outside Diameter: C15 Screen Material: C16 Screen Type: C17 Depth from: C18 Depth to: Slot Size / Perforation: C19 Screen Comments:

WELL DEVELOPMENT AND STATUS

D1 Well Developed by: D2 Well Head Completion: D3 Well Head Stick-up: D4 Static Water Level: D5 Well Yield Estimate: D6 Final Well Status: D7 Well Abandonment Status: D8 Method Used to Estimate Well Yield:

PUMPING TEST RECORD AND GROUNDWATER QUALITY

(All depths below ground, circle appropriate units)

E1 Pumping Test Information

Pumping Test Start Date: Static Water Level (SWL): Pump Intake Set at: Duration of pumping: Final Water Level (FWL) at end of Pumping Test:

RECOMMENDATIONS

Recomm. Pump Depth: Recomm. Pumping Rate: If flowing, provide rate:

F1 Well Water Level Drawdown/Recovery DATA

Table with columns for Drawdown (Time, Water Level) and Recovery (Time, Water Level) at various depths from 0 to 60.

G1 GROUNDWATER QUALITY

Field Data: Date Measurements Taken: Electrical Conductivity: pH: Temperature:

Turbidity/Sand Content

Clear, Slightly turbid/cloudy, Moderately turbid/cloudy, Turbid/cloudy, Trace sand present, No sand present

Bacteria Testing

Was a sample taken? YES NO If yes, indicate name of the labor Date Sample Taken:

Chemical Analysis of Water

Was a sample taken? YES NO If yes, indicate name of the labor Date Sample Taken:

Groundwater Type

Salty, Sulphur / Egg Odour, Organic Taste / Odour, Metallic Taste, Other:

Well Disinfection

Was the well disinfected upon completion of the pump installation? YES NO

Briefly describe method of well disinfection.

CONSULTANT (If applicable)

I 1 Company Name: I 2 Company Address: I 3 Report Reference: I 4 Report Date:

WELL CONTRACTOR

H1 Name of Contractor / Drilling Company: Impact Well Drilling H2 Name of Driller(s): H3 Address of Driller: Date Submitted to Dept. Of Environment

ADDITIONAL INSTRUCTIONS

Upon completing this form, please mail or fax it to:

Water Resources Section (V-310), Department of Environment, Government of Yukon Box 2703, Whitehorse, Yukon, Canada Y1A 2C6

Personal information contained on this form is collected under the authority of the Access to Information and Protection of Privacy (ATIP) Act, Section 29 (c) and will be used to compile a public database of well and ground water information.

Please feel free to contact us at: Phone: (867) 667-3171, Toll free (in Yukon): (1-800) 661-0408, local 3171 Fax: (867) 667-3195 E-mail: Water.Resources@gov.yk.ca

I have read the above clause and understand the purpose for collection of personal information.

Signature of Well Owner