

Property owner's name and address

Cut off Classics
 Whitehorse, VT.
 Carcross Corner
 [Redacted]

Water Well Log

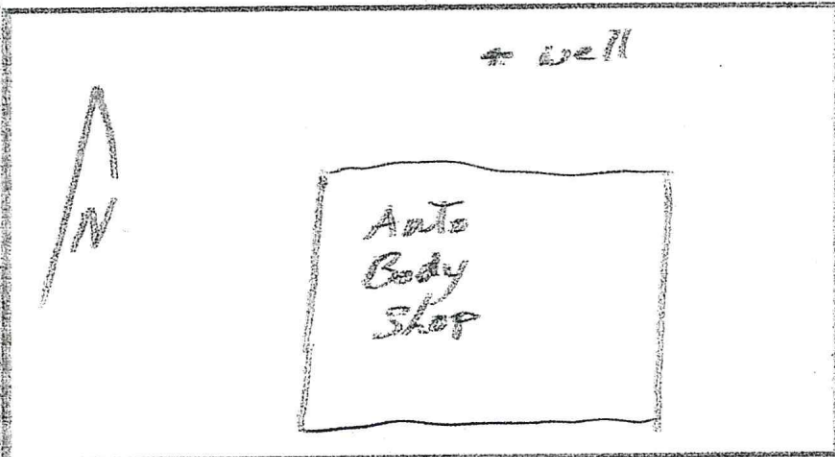

Well site address
 at Body Shop

Sketch map of well location in the box above

Formation log	colour	hardness	from	to
Deepen well from			60	60
Bedrock granite		med to hard	60	155
abit more water at about 100'				

Well depth 155'

Datum point ground

Use Domestic Industrial

Municipal Monitoring

Other

Method of drilling

Cable tool Air rotary

Other

Casing type steel

welded Drill Shoe

shoe ID

Hole diameter
 6" To 60
 4 1/2" To 155

Screen None

Development method duration
 Air 3 hrs

Static water level 29'

Specific capacity 1/2 gpm

Flow rate

Other information

Whitewater Resources
 Box 33012
 Whitehorse, VT. V1A 5V5
 1-(867) 667-6196

Driller: [Redacted]

Date completed
 Apr 26/00