



Yukon Government
 Department of Environment
 Water Resources Section
 Yukon Water Well Registry
 Box 2703 Whitehorse, Yukon, Y1A 2C6

WATER WELL DRILLERS FORM

Well Record Page 1 of 2

Well ID:
 To be assigned by Dept. Of Environment

INSTRUCTIONS FOR COMPLETING THE FORM

1. Additional information is provided at the bottom of this form on page 2.
2. Question can be directed to Water Resources at 867 667-3171.

3. All well construction measurements shall be reported to 0.1 m or 0.3 ft.
4. Please print clearly in blue or black ink.
5. Completion and submission of this form is the responsibility of the drilling contractor.
6. Please specify metric or imperial units for all measurements.

WELL LOCATION AND OWNER'S INFORMATION

A1 Well Name: Optional (i.e. City Well No. 2)
 First Name: [REDACTED] Last Name: [REDACTED] Company / Department / Organization:

A2 Drilled For:

A3 Street Address of Well Location: South Klondike Hwy

A4 Town / Village / Area / Lot #: Lot 125 A

A5 UTM Coordinates (using handheld GPS): NAD 8 3 Zone
 Easting Northing

A6 Elevation of Top of Casing: m / ft ASL

A7 Accuracy of GPS: +/- m / ft

- A8 Purpose of Wells**
- Domestic Test Well Irrigation Environmental (Quality)
 Commercial Municipal Observation - Water Level Other (please identify use)
 Industrial Agricultural Public/Recreational

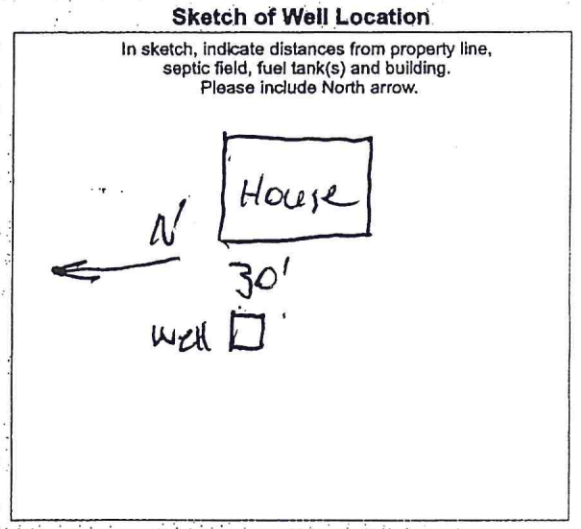

LOG OF OVERBURDEN AND BEDROCK MATERIALS (All depths are below ground surface, circle appropriate units, use descriptors provided)

EXAMPLE ONLY		(brown, grey, green, black, reddish, beige, olive, yellowish)	CLAY, SILT, SAND, GRAVEL, COBBLES, BOULDERS, BEDROCK	"trace" < 10% (i.e. SILT trace gravel) "some" 10-20% (i.e. SAND some gravel) "silty / sandy / gravelly" 20-30% (i.e. silty SAND) "and sand" or "and gravel" 35-50%	MOISTURE: dry / moist / saturated (wet) HARDNESS: soft / hard / very hard	
		brown	SAND	trace gravel some silt	soft and saturated	
Depth (m / ft)	B2 From	B3 To	B4 General Colour	B5 Most Common Material	B6 Secondary Materials	B7 General Description
	0	6	Brown	Sand	Clay + Gravel	Soft
	6	11' 3"	Brown	Clay		Hard
	11' 3"	16' 3"	Brown	Sand	Gravel	Soft
	16' 3"	60'	Grey	Glacial Till		Soft
	60	70		Bed Rock		5 GPM 30' static Head
	200	220		Loose Broken Rock		sealed off
	70	330		Bed Rock		ground water

B8 Permafrost Encountered: NO YES If yes, indicated depth (m / ft): from: 325 to: 330 *Ice Lense*

WELL CONSTRUCTION (Continues on Page 2)

Date Well Completed: 0 2 0 6 2 0 0 5
D D M M Y Y Y Y

Example: 31 01 2005

C1 Drilling Method Air Rotary (Conventional) Dug Other (please specify)
 Reverse Air Rotary Cable Tool
 Mud Rotary Auger (Hollow / Solid Stem)

C2 Well Type: In what geological material is the water producing zone located?
 OVERBURDEN BEDROCK

Casing (depth below ground surface, please circle appropriate units)

C3 Outside Diameter: 6.625 (cm / in)
C4 Casing Material: Steel Plastic Other
C5 Casing Wall Thickness: .250 (cm / in)
C6 Casing Depth to: (m / ft)
C7 Other Comments Regarding Casing: 4" PVC Liner

Surface / Environmental Seal (depth below ground surface, please circle appropriate units)

C8 Seal Material Type: Best Rock (L.s. Bentonite)
C9 Diameter of Seal:
C10 Seal Depth from: 60' (m / ft)
C11 Seal Depth to: 70' (m / ft)
C12 Volume Placed:

Gravel Pack (depth below ground surface, please circle appropriate units)

C13 Gravel Pack: NO If yes, indicated depth (m / ft):
Material type: (i.e. silica)

Well Screen Information (depth below ground surface, please circle appropriate units)

C14 Outside Diameter:
C15 Screen Material: Stainless Steel, Steel, Plastic, N/A, Other
C16 Screen Type: Continuous Wire-Wrap, Louver Screen, Perforated, Slotted, Open Hole
C17 Depth from:
C18 Depth to:
Slot Size / Perforation Dia:
C19 Screen Comments:

WELL DEVELOPMENT AND STATUS

D1 Well Developed by: Surge Block, Water Jetting, Air Jetting / Air Lifting, Bailing, Pumping, Other
D2 Well Head Completion: Well House, Pitless Adaptor, Well Pit (NOT PERMITTED), None
D3 Well Head Stick-up: 18" (m / ft)
D4 Static Water Level: 85 (m / ft)
D5 Well Yield Estimate: 10 GPM (Lps / gpm)
D6 Final Well Status: Water Supply (in use), Stand by (Back-up), Observation, Not in-use, Deepened, Abandoned, Dry, Poor Quality, Insufficient Yield
D7 Well Abandonment Status: Was the well properly decommissioned with bentonite grout? YES NO
D8 Method Used to Estimate Well Yield: Air Lifting, Bailing, Pumping Test

PUMPING TEST RECORD AND GROUNDWATER QUALITY

E1 Pumping Test Information: Pumping Test Start Date: 02/06/2015
Static Water Level (SWL): 85 (m / ft)
Pump Intake Set at:
Duration of pumping:
Final Water Level (FWL) at end of Pumping Test:
RECOMMENDATIONS:
Recomm. Pump Depth: 325' (m / ft)
Recomm. Pumping Rate: 7 GPM (Lps / gpm)
If flowing, provide rate: 10 GPM (Lps / gpm)

F1 Well Water Level Drawdown/Recovery DATA

Table with columns for Time (min), Water Level (m / ft) for Drawdown and Recovery. Rows include 0 (SWL), 1, 2, 3, 4, 5, 10, 15, 20, 25, 30, 40, 50, 60.

G1 GROUNDWATER QUALITY

Field Data: Date Measurements Taken: 11/06/2015
Electrical Conductivity: uS
pH:
Temperature: C
Turbidity/Sand Content: Clear, Slightly turbid/cloudy, Moderately turbid/cloudy, Turbid/cloudy, Trace sand present, No sand present
Well Disinfection: Was the well disinfected upon completion of the pump installation? YES NO
Briefly describe method of well disinfection: Bleach

Bacteria Testing: Was a sample taken? YES NO
Date Sample Taken:
Name of the laboratory: Gilse Hospital
Chemical Analysis of Water: Was a sample taken? YES NO
Date Sample Taken:
Name of the laboratory: OPETWA

WELL CONTRACTOR

H1 Name of Contractor / Drilling Company: 13634 Yukon Inc
H2 Name of Driller(s):
H3 Address of Driller:
Signature of Primary Driller:
Date Submitted to Dept. Of Environment:

CONSULTANT (if applicable)

I-1 Company Name:
I-2 Company Address:
I-3 Report Reference:
I-4 Report Date:

ADDITIONAL INSTRUCTIONS

Upon completing this form, please mail or fax it to: Water Resources Section (V-310), Department of Environment, Government of Yukon, Box 2703, Whitehorse, Yukon, Canada Y1A 2C6
Please feel free to contact us at: Phone: (867) 667-3171, Toll free (in Yukon): (1-800) 661-0408, local 3171
Fax: (867) 667-3195 E-mail: Water.Resources@gov.yk.ca

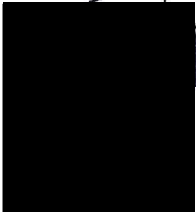

FAXED

2719



Water Analysis

Dealer Name: _____

Customer: Noble

Sample Point: _____

Date: Aug 13/05 Family Size: 5 Tested by: DU

Standard Analysis

Parameters	Maximum Limit	Amount (mg/L)
Manganese	0.05 mg/l	<u>0.1 mg/l</u>
Total Iron	0.30 mg/l	<u>0.2 mg/l</u>
T.D.S.	500 mg/l	<u>300 mg/l</u>
Hardness (CaCO ₃)	500 mg/l	<u>33 sps = 565 ppm</u>
pH	6.5 - 8.5	<u>7.0</u>
Odour	Inoffensive	_____

Appearance of raw sample: clear

Extended Analysis

Parameters	Maximum Limit	Amount (mg/L)
Tannin and Lignin	<0.20 mg/l	_____
Alkallnity	<500 mg/l	_____
Sulfates	500 mg/l	_____
Chlorine-Free	N/A	_____
Chlorine-Total	N/A	_____
Chlorides	≤250mg/l	_____

Recommendations:

*2 cist softener
+ HP + copp. tanks*

339