

WATER WELL RECORD

Date

YR	MO	DAY

 N T S MAP

--	--	--	--	--	--	--	--	--	--

 WELL No.

--	--	--	--	--	--	--	--	--	--

 ELEV

--	--	--	--	--	--	--	--	--	--

 Location Accuracy _____
 U T M

Z									
---	--	--	--	--	--	--	--	--	--

 Date 19__ Well Type _____

 Owners Name & Address _____
 Legal Description & Address Lot 1017 Cookie Rd Lake La Berge YT

- Descriptive Location _____
1. TYPE OF WORK: New Well, Reconditioned, Deepened, Abandoned
2. WORK METHOD: Cable tool, Bored, Jetted, Rotary, Other
3. WATER WELL USE: Domestic, Municipal, Irrigation, Comm. & Ind., Other
4. DRILLING ADDITIVES _____
5. MEASUREMENTS from ground level, top of casing, casing height above ground level _____ ft

9. CASING: Materials Steel, Galvanized, Wood, Plastic, Concrete, Other _____
- | Hole Diameter | | | | | | | | | units |
|---------------|------|--|--|--|--|--|--|--|-------|
| Diameter | 6" | | | | | | | | ins |
| from | | | | | | | | | ft |
| to | | | | | | | | | ft |
| Thickness | 1/4" | | | | | | | | ins |
| Weight | | | | | | | | | lb/ft |
- Pitless unit _____ ft above, below ground level
- Welded, Cemented, Threaded, New, Used
- Perforations: _____

FROM ft	TO ft	6. WELL LOG DESCRIPTION	SWL ft
	35'	Sand	
35			
35	91	Grey soft clay @ 91' static head	70
91	101	Surface water dried up No static head	
101	194	Clay - gravel in last 2' 0"	
194	199	Gravel seam	
		Minimum 10 gpm	
		Static Head	180
		Finished well 197'	

- Shoe(s): Drive shoe - used
- Open hole, from _____ to _____ ft Diameter _____ ins
- Grout: _____
10. SCREEN: Nominal (Telescope), Pipe Size
- Type Continuous Slot, Perforated, Louvre, Other None used
- Material Stainless Steel, Plastic, Other _____
- Set from _____ to _____ ft below ground level

RISER, SCREEN & BLANKS					units
Length					ft
Diam. I D					ins
Slot Size					ins
from					ft
to					ft

- Fittings, top _____ bottom _____
- Gravel Pack _____
11. DEVELOPED BY: Surging, Jetting, Air, Bailing, Pumping, Other _____

12. TEST Pump, Bail, Air Date 04/06/07

Rate 12 USgpm, Temp 3 °C SWL before test 180 ft

Water Level 130 ft after test of _____ hrs 30 days

DRAWDOWN in ft				RECOVERY in ft			
mins	WL	mins	WL	mins	WL	mins	WL
<u>10 Gallons p/m Unlimited</u>							

13. RECOMMENDED PUMP TYPE _____ SETTING _____ PUMPING RATE _____ USgpm

14. WATER TYPE: fresh, salty, clear, cloudy, colour _____ smell _____; gas yes, no

15. WATER ANALYSIS: 1 Hardness _____ mg/L, 2 Iron _____ mg/L, 3 Chloride _____ mg/L, 4 pH _____, Field Date _____, Lab Date _____

SITE I D No _____

7. CONSULTANT _____ Address _____

8. WELL LOCATION SKETCH

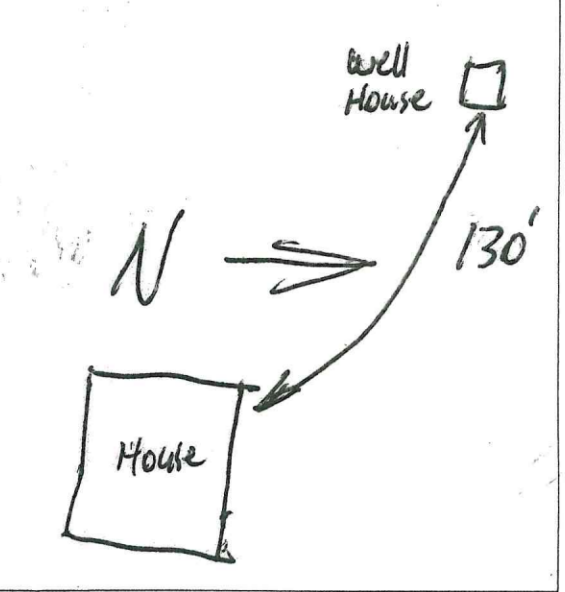

16. FINAL WELL COMPLETION DATA

Well Depth 197 ft, Well Yield 12 USgpm

Static Water Level 180 ft, Artesian Flow _____, US gpm _____, Pressure Head _____ ft

Back filled _____

Well Head Completion Above Ground well seal

17. DRILLER (PLEASE PRINT) _____ SIGNATURE _____

18. CONTRACTOR, Address 13034 Yukon Inc

Member, BCWDA yes, no



WATER WELL RECORD

Date _____

NTS MAP _____ WELL No. _____ ELEV _____ Location Accuracy _____
U M _____ Date 19 _____ Well Type _____

Owners Name & Address _____
Legal Description & Address Lot 1017 Cookie Rd Lake La Berge YT

Descriptive Location

1. TYPE OF WORK
1 New Well 2 Reconditioned
3 Deepened 4 Abandoned
2. WORK METHOD
1 Cable tool 2 Bored 3 Jetted
4 Rotary a mud b air c reverse
 Other _____
3. WATER WELL USE
1 Domestic 2 Municipal 3 Irrigation
4 Comm. & Ind. Other _____
4. DRILLING ADDITIVES _____

9. CASING: 1 Steel 2 Galvanized 3 Wood
Materials 4 Plastic 5 Concrete
 Other _____ units

Hole Diameter	ins
Diameter <u>6"</u>	ins
from _____	ft
to _____	ft
Thickness <u>1/4"</u>	ins
Weight _____	lb/ft

5. MEASUREMENTS from 1 ground level 2 top of casing casing height above ground level _____ ft.

Pitless unit _____ ft 1 above 2 below ground level
1 Welded 2 Cemented 3 Threaded | 1 New 2 Used
Perforations: _____

FROM ft	TO ft	6. WELL LOG DESCRIPTION	SWL ft
	35'	Sand	
35			
35	91	Grey soft clay @ 91' static head	70
91	101	Surface water dried up No static head	
101	194	Clay - Gravel in last 2' 0"	
194	199	Gravel seam	
		Minimum 10 GPM	
		Static Head	180
		Finished well 197'	

Shoe(s): Drive shoe used
Open hole, from _____ to _____ ft Diameter _____ ins
Grout: _____

10. SCREEN: 1 Nominal (Telescope) 2 Pipe Size
Type 1 Continuous Slot 2 Perforated 3 Louvre
 Other None used
Material 1 Stainless Steel 2 Plastic Other _____
Set from _____ to _____ ft below ground level

RISER, SCREEN & BLANKS		units
Length		ft
Diam. I D		ins
Slot Size	<u>NA</u>	ins
from		ft
to		ft

Fittings, top _____ bottom _____
Gravel Pack _____

11. DEVELOPED BY: 1 Surging 2 Jetting 3 Air
4 Bailing 5 Pumping Other _____

12. TEST 1 Pump 2 Bail 3 Air Date 4/10/07
Rate 12 USgpm, Temp 2 °C SWL before test 180' ft
Water Level 130 ft after test of _____ hrs 30 days

DRAWDOWN in ft		RECOVERY in ft					
mins	WL	mins	WL	mins	WL	mins	WL
<u>10 Gallons p/m. Unlimited</u>							

13. RECOMMENDED PUMP TYPE _____ RECOMMENDED PUMP SETTING _____ ft RECOMMENDED PUMPING RATE _____ USgpm

14. WATER TYPE: 1 fresh 2 salty 3 clear 4 cloudy
colour _____ smell _____; gas 1 yes 2 no

15. WATER ANALYSIS: 1 Hardness _____ mg/L
2 Iron _____ mg/L 3 Chloride _____ mg/L
4 pH _____ Field Date _____

7. CONSULTANT _____
Address _____

8. WELL LOCATION SKETCH

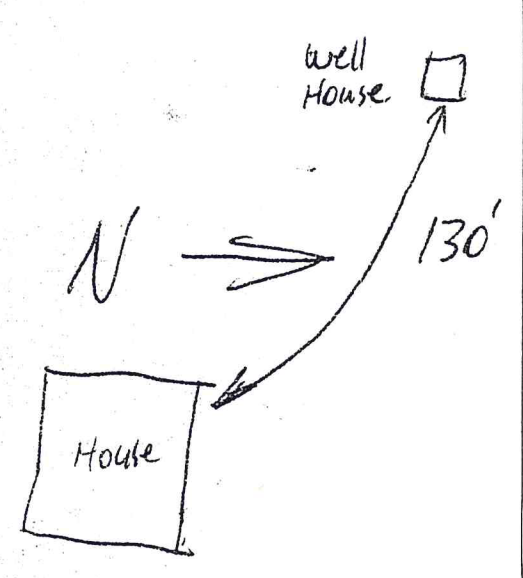

SITE I D No _____ Lab Date _____

16. FINAL WELL COMPLETION DATA
Well Depth 197' ft Well Yield _____ US gpm
Static Water Level 180' ft Artesian Flow _____ US gpm Pressure Head _____ ft
Back filled _____
Well Head Completion Above Ground Well Seal

17. DRILLER PLEASE PRINT _____
Signature _____

18. CONTRACTOR, Address 13034 Yukon Inc

Member, BCWDA yes no ; _____