

204140258/28

COPY



Government  
Department of Environment  
Water Resources Section V-310  
Yukon Water Well Registry  
Box 2703 Whitehorse, Yukon Y1A 2C6

Well Record Page 1 of  
**WATER WELL  
DRILLERS FORM**

Well ID:   
To be assigned by Dept. Of Environment

**INSTRUCTIONS FOR COMPLETING THE FORM**

1. Additional information is provided at the bottom of this form on page 2.
2. Question can be directed to Water Resources at 867 667-3171.
3. All well construction measurements shall be reported to 0.1 m or 0.3 ft.
4. Please print clearly in blue or black ink.
5. Completion and submission of this form is the responsibility of the drilling contractor.
6. Please specify metric or imperial units for all measurements.

**WELL LOCATION AND OWNER'S INFORMATION**

A1 Well Name:  Optional (i.e. City Well No. 2)

A2 Drilled For:  First Name  Last Name  Company / Department / Organization

A3 Street Address of Well Location:  Lot 1016, Shallow Bay

A4 Town / Village / Area / Lot #:  Plan 53244 Quad 105D/14

A5 UTM Coordinates (using handheld GPS): NAD  8 3 Zone  018

4 9 |  3 0 |  1 1 8 Easting  6 7 |  5 6 |  9 1 5 1 9 Northing

A6 Elevation of Top of Casing:  636 (m) / ft ASL

A7 Accuracy of GPS:  5 +/- (m) / ft

**A8 Purpose of Wells**

- Domestic
- Commercial
- Industrial
- Test Well
- Municipal
- Agricultural
- Irrigation
- Observation - Water Level
- Public/Recreational
- Environmental (Quality)
- Other (please identify use)

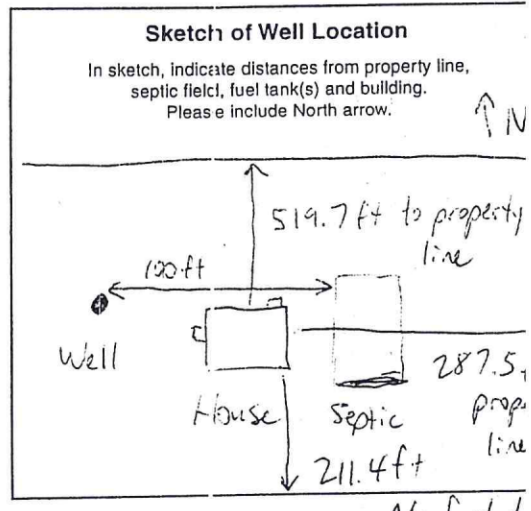

**LOG OF OVERBURDEN AND BEDROCK MATERIALS** (All depths are below ground surface, circle appropriate units, use descriptors provided)

EXAMPLE ONLY		(brown, grey, green, black, redish, beige, olive, yellowish)	CLAY, SILT, SAND, GRAVEL, COBBLES, BOULDERS, BEDROCK	"trace" <10% (i.e. SILT trace gravel) "some" 10-20% (i.e. SAND some gravel) "silty / sandy / gravelly" 20-30% (i.e. silty SAND) "and sand" or "and gravel" 35-50%	MOISTURE: dry / moist / saturated (wet) HARDNESS: soft / hard / very hard
		brown	SAND	trace gravel some silt	soft and saturated
Depth (m / ft)		B4 General Colour	B5 Most Common Material	B6 Secondary Materials	B7 General Description
B2 From	B3 To				
0	20	Brown	Sand		wet
20	185	gray	clay		
185	199	gray	clay	Silt gravel sand	191-199 water
199	220	gray	clay	Silt	
220	240	gray	gravel	sand silt	water bearing

B8 Permafrost Encountered:  NO  YES If yes, indicated depth (m / ft): from:  to:

**WELL CONSTRUCTION** (Continues on Page 2)

Date Well Completed  2 0 1 0 |  9 0 7 |  1 1 3  
Y Y Y Y M M D D

Example:  
2005 01 31

C1 Drilling Method  Air Rotary (Conventional)  Dug  Other (please specify)  
 Reverse Air Rotary  Cable Tool  Dual Rotary  
 Mud Rotary  Auger (Hollow / Solid Stem)

C2 Well Type: In what geological material is water producing zone located  
 OVERBURDEN  BEDROCK

C3 Outside Diameter  6.52 (cm / in)  
C4 Casing Material  Steel  Plastic  Other   
C5 Casing Wall Thickness  2.50 (cm / in)  
C6 Casing Depth to:  23.5 (m / ft)

C7 Other Comments Regarding Casing  
 P.R. Drive Shoe

Surface / Environmental Seal (depth below ground surface, please circle appropriate units)

C8 Seal Material Type: Bentonite (i.e. Bentonite)  
 C9 Diameter of Seal: 10" X 15" (cm / in)  
 C10 Seal Depth from: 0 (m / ft)  
 C11 Seal Depth to: 15 (m / ft)  
 C12 Volume Placed: 4 bags (m<sup>3</sup> / ft<sup>3</sup>)

Gravel Pack (depth below ground surface, please circle appropriate units)

C13 Gravel Pack:  NO If yes, indicated depth ( m / ft ):  
 YES from:  to:  Indicate diameter of material:  ( mm / inches ) Material type:  (i.e. silica)

Well Screen Information (depth below ground surface, please circle appropriate units)

C14 Outside Diameter (cm / in): 6  
 C15 Screen Material:  Stainless Steel  Steel  Plastic  N/A  Other:   
 C16 Screen Type:  Continuous Wire Wrap  Louver Screen  Perforated  Slotted  Open Hole  
 C17 Depth from: Screen 1. 238'8" (m / ft) Screen 2.  (m / ft) Screen 3.  (m / ft)  
 C18 Depth to: 23-1 (m / ft)  (m / ft)  (m / ft)  
 Slot Size / Perforation Dia: 20 Thou. / mm / inches  Thou. / mm / inches  Thou. / mm / inches  
 C19 Screen Comments: Installed 2' view on top of screen

WELL DEVELOPMENT AND STATUS

D1 Well Developed by:  Surge Block  Water Jetting  Air Jetting / Air Lifting  Bailing  Pumping  Other:   
 D2 Well Head Completion:  Well House  Pitless Adaptor Depth of adaptor: 6 (m / ft)  
 Well Pit (NOT PERMITTED)  None (well not completed)  
 D3 Well Head Stick-up (above ground surface): 18" (m / ft) (Use negative if below grade)  
 D4 Static Water Level (below top of casing): 10 (m / ft) (Use negative if below grade)  
 D5 Well Yield Estimate: 20 (Lps / gpm)  
 D6 Final Well Status:  Water Supply (in use)  Not in use  Abandoned  Dry  Stand by (Back-up)  Deepened  Poor Quality  Observation  Other:  If well was abandoned, please give reason:  
 Insufficient Yield  Artesian conditions  
 D7 Well Abandonment Status: Was the well properly decommissioned with bentonite grout?  YES  NO  
 If YES, Indicate Date:   
 D8 Method Used to Estimate Well Yield:  Air Lifting  Bailing  Pumping Test (If test conducted, complete Pumping Test Record)

PUMPING TEST RECORD AND GROUNDWATER QUALITY

(All depths below ground, circle appropriate units)

E1 Pumping Test Information

Pumping Test Start Date:   
 Y Y Y Y M M D D

Static Water Level (SWL):  (m / ft)

Pump Intake Set at:  (m / ft)

Duration of pumping:  hrs  min

Final Water Level (FWL) at end of Pumping Test:  (m / ft)

RECOMMENDATIONS

Recomm. Pump Depth:  (m / ft)  
 Recomm. Pumping Rate:  (Lps / gpm)  
 If flowing, provide rate:  (Lps / gpm)

F1 Well Water Level Drawdown/Recovery DATA

Drawdown		Recovery	
Time (min)	Water Level (m / ft)	Time (min)	Water Level (m / ft)
0 (SWL)		0 (FWL)	
1		1	
2		2	
3		3	
4		4	
5		5	
10		10	
15		15	
20		20	
25		25	
30		30	
40		40	
50		50	
60		60	

G1 GROUNDWATER QUALITY

Field Data  
 Date Measurements Taken:   
 Y Y Y Y M M D D  
 Electrical Conductivity:  uS  
 pH:   
 Temperature:  °C

Turbidity/Sand Content  
 Clear  
 Slightly turbid/cloudy  
 Moderately turbid/cloudy  
 Turbid/cloudy  
 Trace sand present  
 No sand present

Groundwater Type  
 Salty  
 Sulphur / Egg Odour  
 Organic Taste / Odour  
 Metallic Taste  
 Other:

Well Disinfection  
 Was the well disinfected upon completion of the pump installation?  YES  NO  
 Briefly describe method of well disinfection:

Bacteria Testing

Was a sample taken?  YES  NO If yes, indicate the name of the laboratory.  
 Date Sample Taken:   
 Y Y Y Y M M D D

Chemical Analysis of Water

Was a sample taken?  YES  NO If yes, indicate the name of the laboratory.  
 Date Sample Taken:   
 Y Y Y Y M M D D

WELL CONTRACTOR

H1 Name of Contractor / Drilling Company: Impact Well Drilling  
 H2 Name of Driller(s):   
 H3 Address of Driller:   
  
 Signature of Primary Driller:   
 Date Submitted to Dept. Of Environment: 210109110110  
 Y Y Y Y M M D D

CONSULTANT (if applicable)

I 1 Company Name:   
 I 2 Company Address:   
 I 3 Report Reference:   
 I 4 Report Date:   
 Y Y Y Y M M D D

ADDITIONAL INSTRUCTIONS

Upon completing this form, please mail or fax it to:  
 Water Resources Section (V-310), Department of Environment, Government of Yukon Box 2703, Whitehorse, Yukon, Canada Y1A 2C6  
 Please feel free to contact us at:  
 Phone: (867) 667-3171, Toll free (in Yukon): (1-800) 661-0408, local 3171  
 Fax: (867) 667-3195 E-mail: Water.Resources@gov.yk.ca

Personal information contained on this form is collected under the authority of the Access to Information and Protection of Privacy (ATIP) Act, Section 29 (c) and will be used to compile a public database of well and ground water information. For further information contact the Manager of Hydrology, Water Resources at (867) 667-3223, toll free within Yukon 1-800-661-0408 Ext 3223.

I have read the above clause and understand the purpose for collection of personal information.  
 Signature of Well Owner: