

Well ID: **204140329**
To be assigned by Dept. Of Environment

INSTRUCTIONS FOR COMPLETING THE FORM

- Additional information is provided at the bottom of this form on page 2.
- Question can be directed to Water Resources at 867 667-3171.
- All well construction measurements shall be reported to 0.1 m or 0.3 ft.
- Please print clearly in blue or black ink.
- Completion and submission of this form is the responsibility of the drilling contractor.
- Please specify metric or imperial units for all measurements.

WELL LOCATION AND OWNER'S INFORMATION

A1 Well Name: Optional (i.e. City Well Name)

First Name Last Name Company / Department / Organization

A2 Drilled For:

A3 Street Address or Well Location: **TAKHTINI LODGE**
PO BOX 21345 YT, Y1A-6R6

A4 Town / Village / Area / Lot #: **1370, QUAD 10SD/14, YT**
PLAN 99-0143

A5 UTM Coordinates (using handheld GPS):
Zone Easting **1350 478911** Northing **6015 218214**
Easting Northing **30-100m**

A6 Elevation of Top of Casing: **1.5** m (ft) **A.S.L.** **700m A.S.L.**

A7 Accuracy of GPS: **30** +/- m (ft)

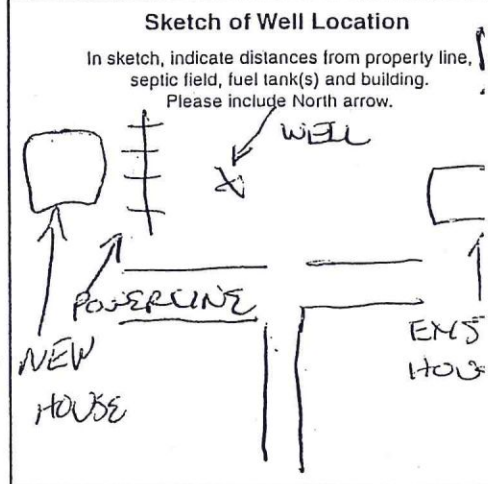

A8 Purpose of Wells

- Domestic
- Commercial
- Industrial
- Test Well
- Municipal
- Agricultural
- Irrigation
- Observation - Water Level
- Public/Recreational
- Environmental (Quality)
- Other (please identify use)

LOG OF OVERBURDEN AND BEDROCK MATERIALS (All depths are below ground surface, circle appropriate units, use descriptors provided)

EXAMPLE ONLY

(brown, grey, green, black, redish, beige, olive, yellowish)

CLAY, SILT, SAND, GRAVEL, COBBLES, BOULDERS, BEDROCK

"trace" <10% (i.e. SILT trace gravel)
"some" 10-20% (i.e. SAND some gravel)
"silty / sandy / gravelly" 20-30% (i.e. silty SAND)
"and sand" or "and gravel" 35-50%

MOISTURE: dry / moist / saturated (HARDNESS: soft / hard / very hard)
soft and saturated

Depth (m / ft)		B4 General Colour	B5 Most Common Material	B6 Secondary Materials	B7 General Description
B2 From	B3 To				
0	5	BRN	SILT		DRY
5	28	BRN/GY	CLAY		HARD
28	35	BRN	CLAY	TRACE FINE-MED	GRAVEL
35	35	BRN	CLAY		
35	300	GY	CLAY		HARD
300	385	GY	CLAY	SILTY SAND	SOFT
385	398	GY	FINE SILTY SAND		SOFT
398	505	GY	BEDROCK		GRANITE

B8 Permafrost Encountered: NO YES If yes, indicated depth (m / ft): from: to:

WELL CONSTRUCTION (Continues on Page 2)

Date Well Completed **20080922**
Y Y Y Y M M D D

Example: 2005 01 31

C1 Drilling Method Air Rotary (Conventional) Dug Other (please specify)
 Reverse Air Rotary Cable Tool
 Mud Rotary Auger (Hollow / Solid Stem)

C2 Well Type: In what geological material is the water producing zone located?
 OVERBURDEN BEDROCK

Casing (depth below ground surface, please circle appropriate units)

C3 Outside Diameter **6** (cm) (in)
C4 Casing Material Steel Plastic Other
C5 Casing Wall Thickness **.219** (cm) (in)
C6 Casing Depth to: **407** (m) (ft)

C7 Other Comments Regarding Casing

4.94 PVC LINES FROM 385-505 BOTTOM SOFT SILT

Surface / Environmental Seal (depth below ground surface, please circle appropriate units)

C8 Seal Material Type: BENTONITE (i.e. Bentonite) C9 Diameter of Seal: 4 (cm) C10 Seal Depth from: 0 (m) C11 Seal Depth to: 15 (m) C12 Volume Placed: 11 BAGS (m³) 3.25

Gravel Pack (depth below ground surface, please circle appropriate units)

C13 Gravel Pack: NO If yes, indicated depth (m / ft): from: to: Indicate diameter of material: (mm / inches) Material type: (i.e. silica)

Well Screen Information (depth below ground surface, please circle appropriate units)

C14 Outside Diameter: 4.94 (cm) C15 Screen Material: Steel C16 Screen Type: Slotted C17 Depth from: 485 (m) C18 Depth to: 505 (m) Slot Size / Perforation Dia: 2 IPCUT Thou. / mm / inches

WELL DEVELOPMENT AND STATUS

D1 Well Developed by: Air Jetting / Air Lifting D2 Well Head Completion: Well House D3 Well Head Stick-up: 1.5 (m) D4 Static Water Level: 46.5 (m) D5 Well Yield Estimate: 2 (Lps / gpm) D6 Final Well Status: Water Supply (in use) D7 Well Abandonment Status: YES D8 Method Used to Estimate Well Yield: Air Lifting

PUMPING TEST RECORD AND GROUNDWATER QUALITY

(All depths below ground, circle appropriate units)

E1 Pumping Test Information

Pumping Test Start Date: Y Y Y Y M M D D

Static Water Level (SWL): (m / ft)

Pump Intake Set at: (m / ft)

Duration of pumping: hrs min

Final Water Level (FWL) at end of Pumping Test: (m / ft)

RECOMMENDATIONS

Recomm. Pump Depth: (m / ft)

Recomm. Pumping Rate: (Lps / gpm)

If flowing, provide rate: (Lps / gpm)

F1 Well Water Level Drawdown/Recovery DATA

Table with 4 columns: Time (min), Water Level (m / ft) for Drawdown and Recovery. Rows include 0 (SWL), 1, 2, 3, 4, 5, 10, 15, 20, 25, 30, 40, 50, 60.

G1 GROUNDWATER QUALITY

Field Data Date Measurements Taken: 20080911 Y Y Y Y M M D D

Electrical Conductivity: uS pH: °C

Groundwater Type

Groundwater Type: Salty, Sulphur / Egg Odour, Organic Taste / Odour, Metallic Taste, Other: IRON

Turbidity/Sand Content

Turbidity/Sand Content: Clear, Slightly turbid/cloudy, Moderately turbid/cloudy, Turbid/cloudy, Trace sand present, No sand present

Well Disinfection

Well Disinfection: Was the well disinfected upon completion of the pump installation? YES

Briefly describe method of well disinfection.

1/2 GAL. 5% FREE TO VC INSTALL 1/2 GAL. AFTER

Bacteria Testing

Bacteria Testing: Was a sample taken? YES Date Sample Taken: 20080922 Y Y Y Y M M D D

Chemical Analysis of Water

Chemical Analysis of Water: Was a sample taken? YES Date Sample Taken: 20080922 Y Y Y Y M M D D

WELL CONTRACTOR

H1 Name of Contractor / Drilling Company: DUBS D DRILLING LTD

H2 Name of Driller(s):

H3 Address of Driller: 1 TERRACE B.C.

Signature of Primary Driller: [Signature]

Date Submitted to Dept. Of Environment: Y Y Y Y M M D D

CONSULTANT (if applicable)

I 1 Company Name:

I 2 Company Address:

I 3 Report Reference:

I 4 Report Date: Y Y Y Y M M D D

ADDITIONAL INSTRUCTIONS

Upon completing this form, please mail or fax it to:

Please feel free to contact us at: Phone: (867) 667-3171, Toll free (in Yukon): (1-800) 661-0408, local 3171 Fax: (867) 667-3195 E-mail: Water.Resources@gov.yk.ca

Water Resources Section (V-310), Department of Environment, Government of Yukon Box 2703, Whitehorse, Yukon, Canada Y1A 2C6

Personal information contained on this form is collected under the authority of the Access to Information and Protection of Privacy (ATIP) Act, Section 29 (c) and will be used to compile a public database of well and ground water information.

I have read the above clause and understand the purpose for collection of personal information.

Signature of Well Owner