

153

Well ID: 2050300209
To be assigned by Dept. Of Environment

105E03

INSTRUCTIONS FOR COMPLETING THE FORM

1. Additional information is provided at the bottom of this form on page 2.
2. Question can be directed to Water Resources at 867 667-3171.
3. All well construction measurements shall be reported to 0.1 m or 0.3 ft.
4. Please print clearly in blue or black ink.
5. Completion and submission of this form is the responsibility of the drilling contractor.
6. Please specify metric or imperial units for all measurements

WELL LOCATION AND OWNER'S INFORMATION

A1 Well Name: Optional (i.e. City Well No. 2)

A2 Drilled For: First Name: Last Name: Company / Department / Organization:

A3 Street Address of Well Location: Quad 105E 3 Lot PCL (AS#274)
LOT #1086

A4 Town / Village / Area / Lot #: Kim 236 north Klondike
Fox Lake

A5 UTM Coordinates (using handheld GPS): NAD 8 3 Zone

Easting Northing

A6 Elevation of Top of Casing: m / ft ASL

A7 Accuracy of GPS: +/- m / ft

A8 Purpose of Wells

- Domestic
- Commercial
- Industrial
- Test Well
- Municipal
- Agricultural
- Irrigation
- Observation - Water Level
- Public/Recreational
- Environmental (Quality)
- Other (please identify use)

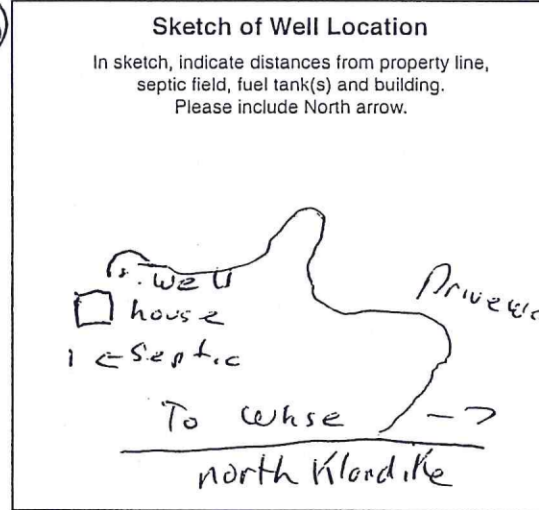

LOG OF OVERBURDEN AND BEDROCK MATERIALS (All depths are below ground surface, circle appropriate units, use descriptors provided)

EXAMPLE ONLY		(brown, grey, green, black, redish, beige, olive, yellowish)	CLAY, SILT, SAND, GRAVEL, COBBLES, BOULDERS, BEDROCK	"trace" <10% (i.e. SILT trace gravel) "some" 10-20% (i.e. SAND some gravel) "silty / sandy / gravelly" 20-30% (i.e. silty SAND) "and sand" or "and gravel" 35-50%	MOISTURE: dry / moist / saturated (wet) HARDNESS: soft / hard / very hard
		brown	SAND	trace gravel some silt	soft and saturated
Depth (m / ft)		B4 General Colour	B5 Most Common Material	B6 Secondary Materials	B7 General Description
B2 From	B3 To				
0	4	brown	gravel		
4	70	brown	sand	clay layers	soft
70	80	grey	clay		dry hard
80	90		gravel	sand	coarse
90	97		gravel		coarse
97	340	black	bedrock		Fractured hard layers

B8 Permafrost Encountered: NO YES If yes, indicated depth (m / ft): from: to:

WELL CONSTRUCTION (Continues on Page 2)

Date Well Completed 20111016
Y Y Y Y M M D D

Example: 2005 01 31

C1 Drilling Method Air Rotary (Conventional) Dug Other (please specify)
 Reverse Air Rotary Cable Tool Dual Rotary
 Mud Rotary Auger (Hollow / Solid Stem)

C2 Well Type: In what geological material is the water producing zone located?
 OVERBURDEN BEDROCK

Casing (depth below ground surface, please circle appropriate units)

C3 Outside Diameter 678 (cm / in)
C4 Casing Material Steel Plastic Other
C5 Casing Wall Thickness 219 (cm / in)
C6 Casing Depth to: 115 (m / ft)

C7 Other Comments Regarding Casing
320 PVC 4.5 well casing installed

Surface / Environmental Seal (depth below ground surface, please circle appropriate units)

C8 Seal Material Type: 15 Bentonite (i.e. Bentonite)
C9 Diameter of Seal: 10 (cm / in)
C10 Seal Depth from: 6 (m / ft)
C11 Seal Depth to: 15 (m / ft)
C12 Volume Placed: (m^3 / ft^3)

Gravel Pack (depth below ground surface, please circle appropriate units)

C13 Gravel Pack: [X] NO If yes, indicated depth (m / ft):
[] YES from: to: Indicate diameter of material: (mm / inches) Material type:

Well Screen Information (depth below ground surface, please circle appropriate units)

C14 Outside Diameter (cm / in)
C15 Screen Material: [] Stainless Steel, [] Steel, [] Plastic, [] N/A, [] Other
C16 Screen Type: [] Continuous Wire Wrap, [] Louver Screen, [] Perforated, [] Slotted, [] Open Hole
C17 Depth from: C18 Depth to: Slot Size / Perforation
Screen 1, 2, 3: (m / ft) (m / ft) Thou. / mm /
C19 Screen Comments:

WELL DEVELOPMENT AND STATUS

D1 Well Developed by: [] Surge Block, [] Water Jetting, [X] Air Jetting / Air Lifting, [] Bailing, [] Pumping, [] Other
D2 Well Head Completion: [] Well House, [X] Pitless Adaptor, [] Well Pit, [] None
D3 Well Head Stick-up (above ground surface): 18 (m / ft)
D4 Static Water Level (below top of casing): 20 (m / ft)
D5 Well Yield Estimate: 21 (Lps / gpm)
D6 Final Well Status: [X] Water Supply (in use), [] Stand by, [] Observation, [] Not in use, [] Deepened, [] Other
D7 Well Abandonment Status: Was the well properly decommissioned with bentonite grout? [] YES, [] NO
D8 Method Used to Estimate Well Yield: [X] Air Lifting, [] Bailing, [] Pumping Test

PUMPING TEST RECORD AND GROUNDWATER QUALITY

E1 Pumping Test Information: Pumping Test Start Date, Static Water Level (SWL), Pump Intake Set at, Duration of pumping, Final Water Level (FWL)
RECOMMENDATIONS: Recomm. Pump Depth, Recomm. Pumping Rate, If flowing, provide rate
F1 Well Water Level Drawdown/Recovery DATA: Table with columns for Time (min) and Water Level (m / ft) for Drawdown and Recovery.

G1 GROUNDWATER QUALITY: Field Data (Date Measurements Taken, Electrical Conductivity, pH, Temperature), Turbidity/Sand Content, Well Disinfection, Bacteria Testing, Chemical Analysis of Water

WELL CONTRACTOR

H1 Name of Contractor / Drilling Company: Rampart Well Drilling
H2 Name of Driller(s):
H3 Address of Driller:
Signature of Primary Driller:
Date Submitted to Dept. Of Environment:

CONSULTANT (If applicable)

I 1 Company Name:
I 2 Company Address:
I 3 Report Reference:
I 4 Report Date:

ADDITIONAL INSTRUCTIONS

Upon completing this form, please mail or fax it to: Water Resources Section (V-310), Department of Environment, Government of Yukon Box 2703, Whitehorse, Yukon, Canada Y1A 2C6
Please feel free to contact us at: Phone: (867) 667-3171, Toll free (in Yukon): (1-800) 661-0408, local 3171 Fax: (867) 667-3195 E-mail: Water.Resources@gov.yk.ca

Personal information contained on this form is collected under the authority of the Access to Information and Protection of Privacy (ATIPP) Act, Section 29 (c) and will be used to compile a public database of well and ground water information. For further information contact the Manager of Hydrology, Water Resources at (867) 667-3223, toll free within Yukon 1-800-661-0408 Ext 3223.
I have read the above clause and understand the purpose for collection of personal information.
Signature of Well Owner