

Well ID:   
To be assigned by Dept. Of Environment

**INSTRUCTIONS FOR COMPLETING THE FORM**

1. Additional information is provided at the bottom of this form on page 2.
2. Question can be directed to Water Resources at 867 667-3171.
3. All well construction measurements shall be reported to 0.1 m or 0.3 ft.
4. Please print clearly in blue or black ink.
5. Completion and submission of this form is the responsibility of the drilling contractor.
6. Please specify metric or imperial units for all measurements.

**WELL LOCATION AND OWNER'S INFORMATION**

A1 Well Name:  Optional (i.e. City Well No. 2)

A2 Drilled For:  First Name  Last Name  Company / Department / Organization

A3 Street Address of Well Location:  Lot 341 Miners Ridge  
Plan 06-162 Quad 105 D/14

A4 Town / Village / Area / Lot #:  Whitehorse

A5 UTM Coordinates (using handheld GPS): NAD  8  3 Zone    
Easting       Northing

A6 Elevation of Top of Casing:  m / ft ASL

A7 Accuracy of GPS:  +/- m / ft

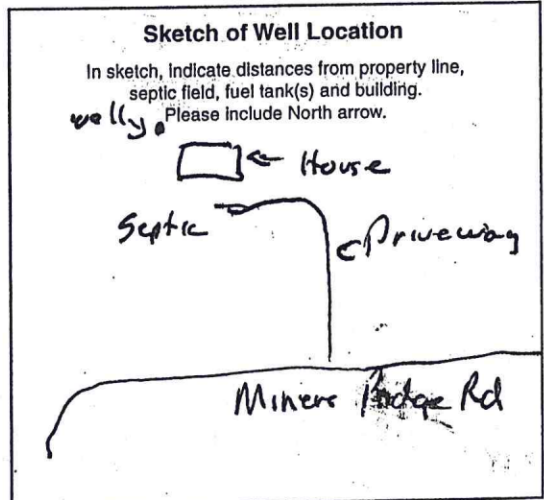

**A8 Purpose of Wells**

- Domestic
- Commercial
- Industrial
- Test Well
- Municipal
- Agricultural
- Irrigation
- Observation - Water Level
- Public/Recreational
- Environmental (Quality)
- Other (please identify use)

**LOG OF OVERBURDEN AND BEDROCK MATERIALS** (All depths are below ground surface, circle appropriate units, use descriptors provided)

| EXAMPLE ONLY   |       | (brown, grey, green, black, redish, beige, olive, yellowish) | CLAY, SILT, SAND, GRAVEL, COBBLES, BOULDERS, BEDROCK | "trace" <10% (i.e. SILT trace gravel)<br>"some" 10-20% (i.e. SAND some gravel)<br>"silty / sandy / gravelly" 20-30% (i.e. silty SAND)<br>"and sand" or "and gravel" 35-50% | MOISTURE: dry / moist / saturated (wet)<br>HARDNESS: soft / hard / very hard |
|----------------|-------|--|--|--|--|
|                |       | brown  | SAND   | trace gravel some silt   | soft and saturated   |
| Depth (m / ft) |       | B4 General Colour  | B5 Most Common Material                              | B6 Secondary Materials   | B7 General Description   |
| B2 From        | B3 To |  |  |  |  |
| 0              | 8     | Brown  | Silt   | Sand   | dry  |
| 8              | 94    | grey   | Clay   | Silt   | dry  |
| 94             | 104   | grey   | Silt   | Sand gravel  | dry  |
| 104            | 116   | Black  | Rock   |  | Fractured  |
| 116            | 225   | grey + black   | Bedrock  |  | soft-hard  |

B8 Permafrost Encountered:  NO  YES If yes, indicated depth (m / ft): from  to

**WELL CONSTRUCTION** (Continues on Page 2)

Date Well Completed  20080711  
Y Y Y Y M M D D

Example: 2005 01 31

C1 Drilling Method  Air Rotary (Conventional)  Dug  Other (please specify)   
 Reverse Air Rotary  Cable Tool  
 Mud Rotary  Auger (Hollow / Solid Stem)

C2 Well Type: In what geological material is the water producing zone located?  
 OVERBURDEN  BEDROCK

Casing (depth below ground surface, please circle appropriate units)  
C3 Outside Diameter  67.9 (cm / in)  
C4 Casing Material  Steel  Plastic  Other   
C5 Casing Wall Thickness  2.9 (cm / in)  
C6 Casing Depth to:  116 m / ft  
PVC casing 115'-255'

C7 Other Comments Regarding Casing:  
 Strategy casing shoe

Surface / Environmental Seal (depth below ground surface, please circle appropriate units)

C8 Seal Material Type: Bentonite (i.e. Bentonite)
C9 Diameter of Seal: 10" x 15' (cm / in)
C10 Seal Depth from: (m / ft)
C11 Seal Depth to: (m / ft)
C12 Volume Placed: (m³ / ft³)

Gravel Pack (depth below ground surface, please circle appropriate units)

C13 Gravel Pack: NO YES
If yes, indicated depth (m / ft):
Indicate diameter of material: (mm / inches)
Material type: (i.e. silica)

Well Screen Information (depth below ground surface, please circle appropriate units)

C14 Outside Diameter (cm / in)
C15 Screen Material: Stainless Steel, Steel, Plastic, N/A, Other
C16 Screen Type: Continuous Wire Wrap, Louver Screen, Perforated, Slotted, Open Hole
C17 Depth from: Screen 1, 2, 3 (m / ft)
C18 Depth to: (m / ft)
Slot Size / Perforation Dia: (Thou. / mm / inches)
C19 Screen Comments:

WELL DEVELOPMENT AND STATUS

D1 Well Developed by: Surge Block, Water Jetting, Air Jetting / Air Lifting, Bailing, Pumping, Other
D2 Well Head Completion: Well House, Wellless Adaptor, Well Pit (NOT PERMITTED), None
D3 Well Head Stick-up (above ground surface): 5' (m / ft)
D4 Static Water Level (below top of casing): 3.4' (m / ft)
D5 Well Yield Estimate: 2.5 (Lps / gpm)
D6 Final Well Status: Water Supply (in use), Stand by (Back-up), Observation, Not in use, Deepened, Other
D7 Well Abandonment Status: Was the well properly decommissioned with bentonite grout? YES NO
D8 Method Used to Estimate Well Yield: Air Lifting, Bailing, Pumping Test

PUMPING TEST RECORD AND GROUNDWATER QUALITY

(All depths below ground, circle appropriate units)

E1 Pumping Test Information

Pumping Test Start Date: (Y Y Y Y M M D D)

Static Water Level (SWL): (m / ft)

Pump Intake Set at: (m / ft)

Duration of pumping: ( ) hrs ( ) min

Final Water Level (FWL) at end of Pumping Test: (m / ft)

RECOMMENDATIONS

Recomm. Pump Depth: (m / ft)
Recomm. Pumping Rate: (Lps / gpm)
If flowing, provide rate: (Lps / gpm)

F1 Well Water Level Drawdown/Recovery DATA

Table with 4 columns: Time (min), Water Level (m / ft), Time (min), Water Level (m / ft). Rows for Drawdown and Recovery from 0 to 60 minutes.

G1 GROUNDWATER QUALITY

Field Data

Date Measurements Taken: (Y Y Y Y M M D D)

Electrical Conductivity: ( ) uS
pH: ( )
Temperature: ( ) °C

Turbidity/Sand Content

Clear, Slightly turbid/cloudy, Moderately turbid/cloudy, Turbid/cloudy, Trace sand present, No sand present

Well Disinfection

Was the well disinfected upon completion of the pump installation? YES NO

Briefly describe method of well disinfection.

3 bleach

Bacteria Testing

Was a sample taken? YES NO
Date Sample Taken: ( ) ( ) ( ) ( ) ( ) ( )

Chemical Analysis of Water

Was a sample taken? YES NO
Date Sample Taken: ( ) ( ) ( ) ( ) ( ) ( )

WELL CONTRACTOR

H1 Name of Contractor / Drilling Company: IMPACT WELL DRILLING

CONSULTANT (If applicable)

I 1 Company Name:
I 2 Company Address:
I 3 Report Reference:
I 4 Report Date: ( ) ( ) ( ) ( ) ( ) ( )

Date Submitted to Dept. Of Environment

ADDITIONAL INSTRUCTIONS

Upon completing this form, please mail or fax it to:

Please feel free to contact us at:
Phone: (867) 667-3171, Toll free (in Yukon): (1-800) 661-0408, local 3171
Fax: (867) 667-3195 E-mail: Water.Resources@gov.yk.ca

Water Resources Section (V-310), Department of Environment, Government of Yukon Box 2703, Whitehorse, Yukon; Canada Y1A 2C6

Personal information contained on this form is collected under the authority of the Access to Information and Protection of Privacy (ATIPP) Act, Section 29 (c) and will be used to compile a public database of well and ground water information.

I have read the above clause and understand the purpose for collection of personal information.

Signature of Well Owner